

Important Safety Instructions:

Basic safety precautions should always be followed when installing, including the following:

1. Read all instructions.
2. Licensed electrician for installation only.
3. Always ensure the power is OFF and the fitting has cooled down before performing any maintenance, cleaning, or adjustment to the fitting.
4. Do not install any luminaire near the heat source.
5. Do not exceed the nominal supply voltage or amperage ratings.
6. To avoid injury or damage to the fitting, please ensure that power leads and screws are secure before connecting the power.
7. Isolated dimming.
8. After the dimming circuit is connected to 0-10V dimming signal, the lamps can be dimmed, and the dimming range is 8%-100%.
9. dim+ purple; dim- gray, please refer to step2 for wiring details.
10. The load current of the dimmable lamp wire is less than 0.1mA. When connecting the dimmer, please refer to the current of the dimmer specification. The total current of the connected lamp should not exceed the current limit of the dimmer.
11. Please ensure that the leakage current of the dimming control circuit is less than 3.5mA.

Installation Instruction

WARNING

1. Switch off before installation.
2. Switch on only after complete installation and examination of the circuit.
3. Professional electrician for installation and maintenance only.

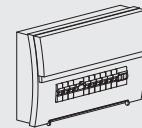

**Turn Off
Power Supply**

Turn Off power supply before starting any installation. Read instructions & check you have all the tools & accessories to complete the installation correctly.

Step 1

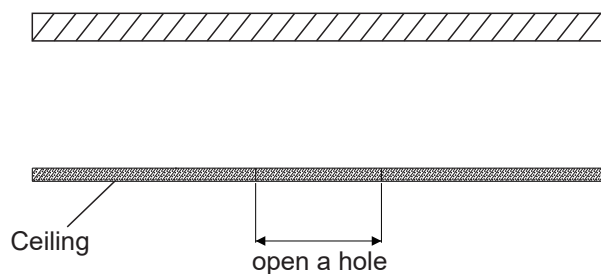

The height of the fixture should be no less than 100mm

Opening a hole in ceiling according to cutout size of the lamp

Step 2

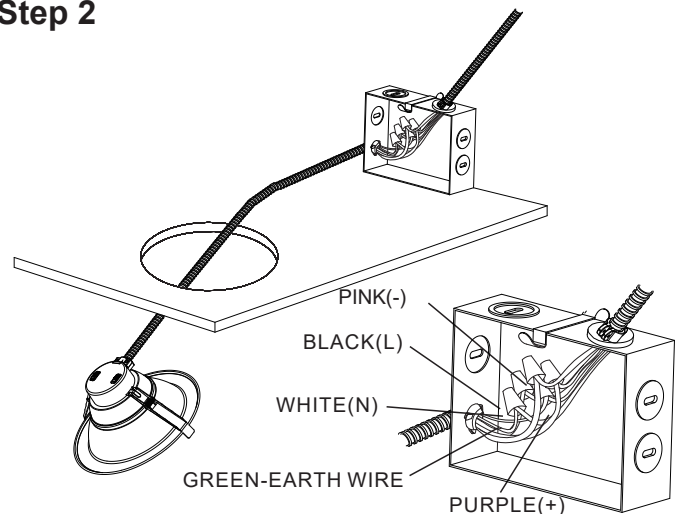

Connect AC and Dimming wire correspondingly as shown in picture

Step 3

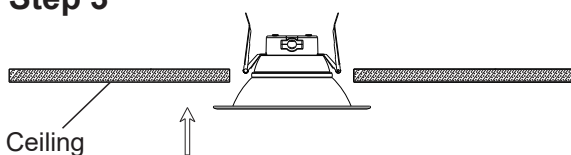

Bend back the spring clips then push the lamp into the hole.

Step 4

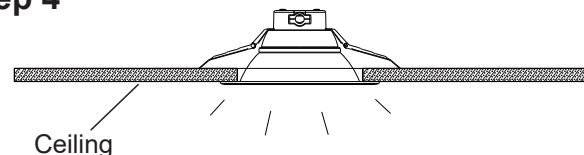

Installation completed. Switch on.

